

VAISHAL PATLIPUTRA DUGDH UTPADAK SAHKARI SANGH LTD

PATNA DAIRY PROJECT

Feeder Balancing Dairy Complex, Phulwarisharif, Patna – 801505

An ISO 22000:2005 Certified Organisation

Phone 0612-2252553, 2252542, 2251622, Fax 2250325

E.mail: vpmu.pur@gmail.com

GST no. 10AAAV8463B1ZV

Tender Notice

PDP: PUR: FBD: 3033

Dated: 07.07.2025

Sealed tenders are invited from civil contractors registered with Building Construction works Department, Rural Works Department, Water Resource Department, Government of Bihar OR registered with COMFED in suitable class for the civil work as given below :-

| Sl no. | Name of Work | Estimated Cost (In Rs.) | Amount of EMD (In Rs.) | Cost of BOQ (In Rs.) | Time of Completion |
|--------|--------------------------------------------------------------------------------------------------------------------------------------------------------------------------------------------------------------------------------------------------------------------|-------------------------|------------------------|-----------------------|--------------------|
| | Civil construction work of construction of road from main gate to Industrial drain near main road along with bumper and water breaker to avoid entry of rain water in Hajipur Dairy. The details scope of work as per BOQ and diagrams attached herewith | 5,90,825.00 | 11817.00 | 1000.00 | 45 days |

- (1) Tender document can be obtained from the Cashier at office (Patna Dairy Project), VPDUSS Ltd during office hours OR it may be downloaded from website – www.patnadairy.org up to **28.07.2025 at 3.00 pm**. Downloaded BOQ must be accompany with DD of BOQ Cost. DD of any nationalized bank shall be submitted in favour of “**Vaishal Patliputra Dugdh Utpadak Sahkari Sangh Ltd.**”, Payable at **Patna**
- (2) Contractors who down load the tender and those who purchase the **tender / BOQ** directly from office at Patna Dairy Project, both will send their completed tender in a sealed envelope **through registered post or through courier to Purchase section at Patna Dairy Project address.**
- (3) Last date of receipt of completed tender – **29.07.2025 up to 3:00 pm**. Tenders received **after due date & time shall not to be considered.**
- (4) Date of **opening all received tenders-30.07.2025 at 3:00pm** in the presence of the tenders of their authorized agent in the office of Patna Dairy Project, VPMU.
- (5) Tenders received after due date & time shall not be considered.

Undersigned reserves the right to extend the dates OR cancel the tender.

Managing Director

BOQ FOR CIVIL CONSTRUCTION WORK FOR CONSTRUCTION OF ROAD FROM MAIN GATE TO INDUSTRIAL DRAIN NEAR MAIN ROAD ALONG WITH A WATER BREAKER TO AVOID ENTRY OF RAIN WATER IN HAJIPUR DAIRY, HAJIPUR.

| Sr. | BSOR-22 | DESCRIPTION OF WORK | UNIT | RATE | QUANTITY | AMOUNT |
|-----|---------|----------------------------------------------------------------------------------------------------------------------------------------------------------------------------------------------------------------------------------------------------------------------------------------------------------------------------------------------------------------|------|---------|----------|-----------------|
| 1 | 20.3A.1 | Making 25cm (10") dia bore upto 4mtr depth below ground with hand auger of approved quality in ordinary soil (vide classification of soil item A) true to plumb and without eccentricity in any stage of operation and disposal of the excavated earth upto 50 mtr, Lead including all lifts, all complete as per approved design and direction of E/I | Mtr. | 178.30 | 18.00 | Rs. 3,209.40 |
| 2 | 20.3A.2 | 63CM (25) UNDER-REAM Making 63cm (25) dia under ream at required with hand auger of approved quality in ordinary soil (vide classification of soil item A) true to plumb and without eccentricity in any stage of operation and disposal of the excavated earth upto 50 m lead including all lifts, all complete as per approved design and direction of (E/I) | each | 190.20 | 6.00 | Rs. 1,141.20 |
| 3 | 2.8.1 | Earth work in excavation in foundation trenches or drains (not exceeding 1.5 m in width or 10 sqm on plan) including dressing of sides and ramming of bottoms, lift upto 1.5 m. including getting out the excavated soil and disposal of surplus excavated soil as directed, within a lead of 50 m: All Kinds of soil | Cum. | 360.70 | 23.09 | Rs. 8,328.56 |
| 4 | 16.1 | Preparing and consolidation of sub grade with power road roller of 8 to 12 tonne capacity after excavating earth to an average of 22.5 cm depth, dressing to camber and consolidating with road roller including making good the undulations etc. and re-rolling the sub grade and disposal of surplus earth with lead upto 50 metres | Sqm. | 90.70 | 77.20 | Rs. 7,002.04 |
| 5 | 2.26 | Filling available excavated earth (excluding rock) in trenches, plinth, sides of foundations etc. in layers not exceeding 20 cm in depth: consolidating each deposited layer by ramming and watering lead up to 50 mtr. 123.90 | Cum. | 123.90 | 11.55 | Rs. 1,431.05 |
| 6 | 2.28 | Supplying and Filling in plinth with local sand and under floors including, watering, ramming consolidating and dressing complete | Sqm. | 287.30 | 11.25 | Rs. 3,232.13 |
| 7 | 11.72 | Providing designation 100A one brick flat soling joints filled with local sand including cost of watering, taxes, royalty all complete as per building specification and direction of E/I, | Sqm. | 283.30 | 6.63 | Rs. 1,878.28 |
| 8 | 11.73 | Providing designation 100 A one brick on edge soling joints filled with local sand including cost of watering, taxes, royalty all complete as per building specification and direction of E/I, | Sqm. | 444.80 | 75.00 | Rs. 33,360.00 |
| 9 | 4.1 | Providing and laying in position cement concrete of specified grade excluding the cost of centring and shuttering-all work upto plinth level. | | | | |
| | 4.1.6 | 1:3:6 (1 Cement; 3 coarse sand : 6 graded stone aggregate 40 mm nominal size) | Cum. | 3279.80 | 13.13 | Rs. 43,063.77 |
| 10 | 5.1 | Providing and laying in position specified grade of reinforced cement concrete excluding the cost of centring, shuttering, finishing and reinforcement-All work upto plinth level | | | | |
| | 5.1.2 | 1:1:5:3 (1 cement: 1.5 coarse sand: 3 graded stone aggregate 20 mm nominal size) cum 4688.30 | Cum | 4689.30 | 40.60 | Rs. 1,90,385.58 |
| 11 | 5.22 | Reinforcement for R.C.C. work including straightening, cutting, bending, placing in position and binding all complete | | | | |

Aditya Bauran

Aditya Bauran

BILL OF QUANTITY

2

| Sr. | BSOR-22 | DESCRIPTION OF WORK | UNIT | RATE | QUANTITY | AMOUNT |
|---------------------------------------------------------|--------------------------------------------------|------------------------------------------------------------------------------------|---------------------------------------------------------------------------------------------------------|--------|----------|-----------------|
| | 5.22.7A | Thermo-Mechanically Treated bars TMTC-500-8mm dia. | Kg. | 94.50 | 151.99 | Rs. 14,363.06 |
| | 5.22.7B | Thermo-Mechanically Treated bars TMTC-500-10mm dia. | Kg. | 92.60 | 633.97 | Rs. 58,705.44 |
| | 5.22.7C | Thermo-Mechanically Treated bars TMTC-500-12mm dia. | Kg. | 90.80 | 203.89 | Rs. 18,512.76 |
| 12 | 5.9 | Centring and shuttering including strutting,propping etc. and removal of form for. | | | | |
| | 5.9.1 | Foundations, footings, bases of columns etc. for mass concrete. | Sqm. | 211.60 | 30.00 | Rs. 6,348.00 |
| TOTAL SUM | | | | | | Rs. 3,90,961.27 |
| CARRIAGE OF MATERIALS & DIFFERENCE OF COST OF MATERIALS | | | | | | |
| 13 | I | Carriage of Materials | | | | |
| | a | Graded Stone aggregate | Cum. | 46.850 | 2987.70 | 1,39,973.75 |
| | b | Coarse sand | Cum. | 23.420 | 1258.33 | 29,470.09 |
| | c | Bricks 8km | % | 4.463 | 1053.35 | 4,701.10 |
| | d | Reinforcement (Steel) | Tonne | 1.086 | 492.75 | 535.13 |
| | e | Cement | Tonne | 19.128 | 492.75 | 9,425.32 |
| | f | Local sand | Cum. | 11.250 | 322.81 | 3,631.61 |
| 14 | II | Difference of Cost of Materials | | | | |
| | a | Bricks | % | 4.463 | 1590.97 | 7,100.50 |
| | b | Cement | Tonne | 19.128 | 262.78 | 5,026.46 |
| 15 | TOTAL COST OF CIVIL CONSTRUCTION WORK | | | | | Rs. 5,90,825.23 |
| 16 | TOTAL COST OF CIVIL CONSTRUCTION WORK(ROUND OFF) | | | | | Rs. 5,90,825.00 |
| S.NO. | I AM AGREE TO DO THIS WORK | | IN % | | IN WORDS | |
| | ON THE BOQ RATE | | | | | |
| | BELOW THE GIVEN RATE (IN %) | | | | | |
| | ABOVE THE GIVEN RATE (IN %) | | | | | |
| SIGNATURE OF CONTRACTOR WITH SEAL | | |  MANAGER(Engg.) | | | |

Aditya Saurav

MEASUREMENT SHEET FOR CIVIL CONSTRUCTION WORK FOR CONSTRUCTION OF ROAD FROM MAIN GATE TO INDUSTRIAL DRAIN NEAR MAIN ROAD ALONG WITH A WATER BREAKER TO AVOID ENTRY OF RAIN WATER IN HAIPUR DAIRY, HAIPUR

| Sl. | BSR-22 | DESCRIPTION OF WORK | UNIT | NO. | LENGTH | WIDTH | DEPTH | QUANTITY | Stone | Sand | Cement |
|-----|---------|---------------------------------------------------------------------------------------------------------------------------------------------------------------------------------------------------------------------------------------------------------------------------------------------------------------------------------------|------|-----|--------|-------|-------|----------|-------|------|--------|
| 1 | 20.3A.1 | 250MM DIA PILE 3 M DEEP WITH SINGLE UNDER REAMED | MTR. | 6 | | | | | | | |
| 2 | 20.3A.2 | UNDER REAMED | No. | 6 | | | 3.00 | 18.00 | | | |
| 3 | 2.8 | Earth work in excavation in foundation trenches or drains(not exceeding 1.5 m in width or 10 sqm on plan) including dressing of sides and ramming of bottoms, lift upto 1.5 m . including getting out the excavated soil and disposal of surplus excavated soil as directed, within a lead of 50 m: All Kinds of soil | | | | | | 6.00 | | | |
| | | RCC ROAD AREA | | | | | | | | | |
| | | BEAM | Cum. | 1 | 11.00 | 6.00 | 0.30 | 19.80 | | | |
| | | TRIANGULAR PORTION 1/2 lxb | Cum. | 1 | 26.50 | 0.30 | 0.30 | 2.39 | | | |
| | | | | 1 | 3.00 | 3.00 | 0.30 | 0.90 | | | |
| 4 | 16.1 | Preparing and consolidation of sub grade with power road roller of 8 to 12 tonne capacity after excavating earth to an average of 22.5 cm depth, dressing to camber and consolidating with road roller including making good the undulations etc. and re-rolling the sub grade and disposal of surplus earth with lead upto 50 metres | Cum. | | | | | 23.09 | | | |
| | | RCC ROAD AREA | | | | | | | | | |
| | | TRIANGULAR PORTION 1/2 lxb | Sqm | 1 | 11.00 | 6.20 | | 68.20 | | | |
| | | | Sqm | 1 | 3.00 | 3.00 | | 9.00 | | | |
| 4 | 2.26 | Filling available excavated earth (excluding rock) in trenches, plinth, sides of foundations etc. in layers not exceeding 20 cm in depth: consolidating each deposited layer by ramming and watering lead up to 50 mtr. 123.90 | | | | | | 77.20 | | | |
| | | 50% of excavated soil | Cum. | | | | | 11.55 | | | |

Aditya Pareek

(Signature)

| Sr. | BSR-22 | DESCRIPTION OF WORK | UNIT | NO. | LENGTH | WIDTH | DEPTH | QUANTITY | Stone | Sand | Cement |
|-----|--------|------------------------------------------------------------------------------------------------------------------------------------------|------|-----|--------|-------|---------|----------|---------|-------|--------|
| 5 | 2.28 | Supplying and Filling in plinth with local sand and under floors including, watering, ramming consolidating and dressing complete.287.30 | | | | | | | | | |
| | | Under RCC ROAD | | 1 | 11.00 | 6.00 | 0.15 | 9.90 | | | |
| | | TRANGULAR PORTION | | 1 | 3.00 | 3.00 | 0.15 | 1.35 | | | |
| | | | Cum. | | | | | 11.25 | | | |
| 6 | 11.72 | BRICK FLAT SOLING UNDER BEAM | Sqm. | 1 | 26.50 | 0.25 | | 6.63 | | | |
| 7 | 11.73 | BRICK EDGE SOLING | | | | | | | | | |
| | | UNDER ROAD | | 1 | 11.00 | 6.00 | | 66.00 | | | |
| | | TRANGULAR PORTION both side near main road | | 1 | 3.00 | 3.00 | | 9.00 | | | |
| | | | Sqm. | | | | | 75.00 | | | |
| 8 | 4.1.5 | PCC IN 1:3:6 | | | | | | | | | |
| | | PCC In road surface making | Cum. | 1 | 11.00 | 6.00 | 0.175 | 11.55 | | | |
| | | rounded area near mai road | | 1 | 3.00 | 3.00 | 0.175 | 1.58 | | | |
| | | | Cum. | | | | | 13.13 | 12.34 | 6.17 | 2.89 |
| 9 | 5.1.2 | RCC IN FOUNDATION BED | | | | | | | | | |
| | | PILE | | 6 | 3.14 | 0.016 | 3.00 | 0.90 | | | |
| | | BULB | | 6 | 0.023 | | | 0.140 | | | |
| | | BEAM | | 1 | 26.500 | 0.25 | 0.40 | 2.650 | | | |
| | | | | | | | | | | | |
| | | R.C.C Road main area | | 1 | 11.00 | 6.00 | 0.190 | 12.54 | | | |
| | | R.C.C road rounded or angular | | 1 | 3.00 | 3.00 | 0.190 | 1.71 | | | |
| | | water Stopper rounded shape | | 1 | 26.50 | 4.50 | 0.190 | 22.66 | | | |
| | | | Cum. | | | | | 40.60 | 34.51 | 17.26 | 16.24 |
| | | | | | | | | | 46.85 | 23.43 | 19.13 |
| | | | | | | | | | Stone | Sand | Cement |
| 10 | 5.22 | Reinforcement | | | | | 12Ø | 10Ø | 8Ø | | |
| | | beam 8-12 dia tor | 2 | 4 | 26.90 | 0.888 | 191.098 | | | | |
| | | lap | 2 | 12 | 0.60 | 0.888 | 12.787 | | | | |
| | | 8dia @150c/c | 1 | 177 | 1.64 | 0.395 | | | 114.660 | | |
| | | Pile 10 diator | 6 | 5 | 3.65 | 0.617 | | 67.562 | | | |

Consultant: DEV-CHANDRA CREATIVE ASSOCIATES

Aditya & avelay

Kbali

| Sr. | BSR-22 | DESCRIPTION OF WORK | UNIT | NO. | LENGTH | WIDTH | DEPTH | QUANTITY | | | |
|-----|--------|-----------------------|------|-----|--------|-------|---------|----------|---------|-------------|--------|
| | | | | | | | | | Stone | Sand | Cement |
| | | 8 dia ring 150 c/c | 6 | 21 | 0.75 | 0.395 | | | 37.330 | | |
| | | Road 10 dia tor | 1 | 74 | 6.20 | 0.617 | | 283.080 | 0.000 | | |
| | | short length | 1 | 41 | 11.20 | 0.617 | | 283.326 | 0.000 | | |
| | | | Kg. | | | | 203.885 | 633.968 | 151.990 | 1.086 tonne | |
| 11 | | CENTRING & SHUTTERING | | | | | | | | | |
| | | PCC IN 1:3:6 | | | | | | | | | |
| | | PCC IN Foundation Bed | Sqm. | 2 | 11.00 | | 0.20 | 4.40 | | | |
| | | | Sqm. | 2 | 11.00 | | 0.20 | 4.40 | | | |
| | | RCC IN BEAM | Sqm. | 2 | 26.50 | | 0.40 | 21.20 | | | |
| | | | Sqm. | | | | | 30.00 | | | |

Aditya & Anand

Red

CIVIL CONSTRUCTION WORK FOR THE CONSTRUCTION OF ROAD FROM MAIN GATE TO INDUSTRIAL DRAIN AT HAJIPUR DAIRY PLANT

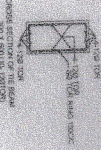
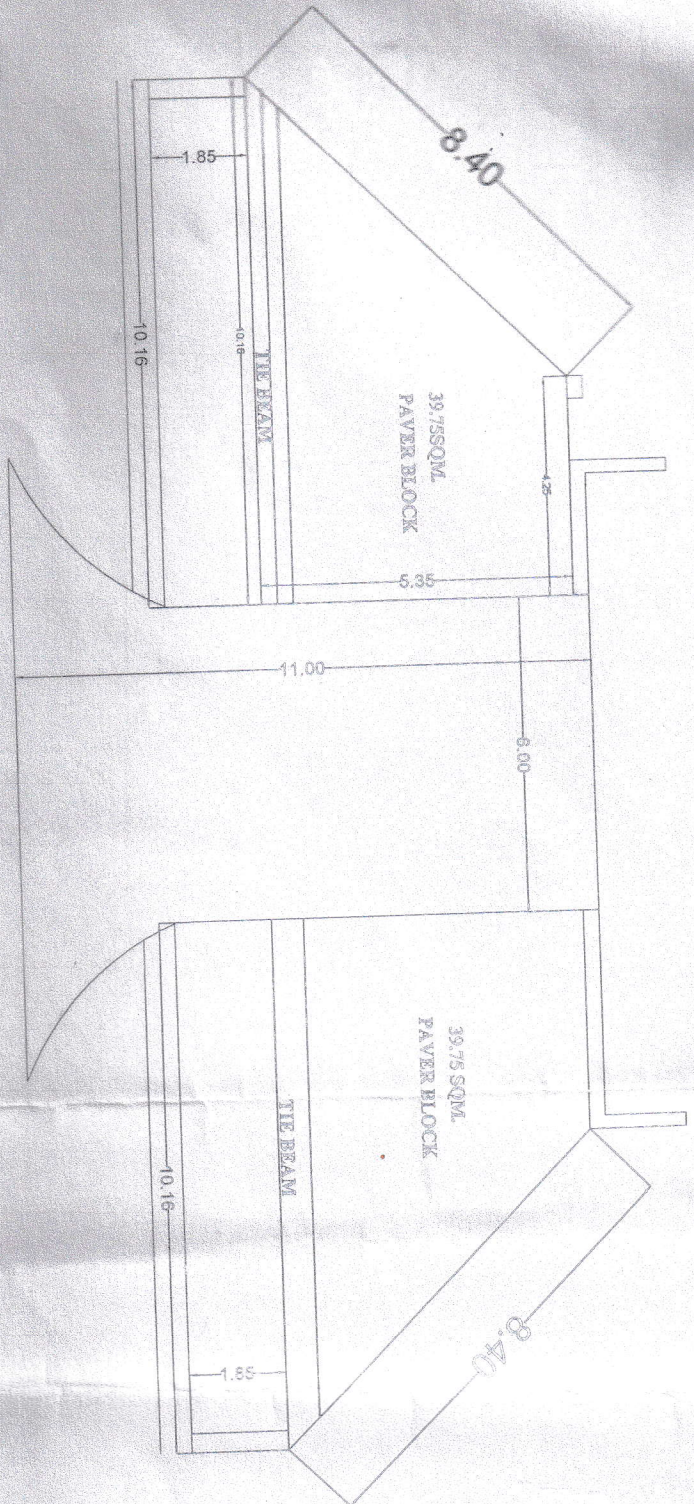

CROSS SECTION OF ROAD

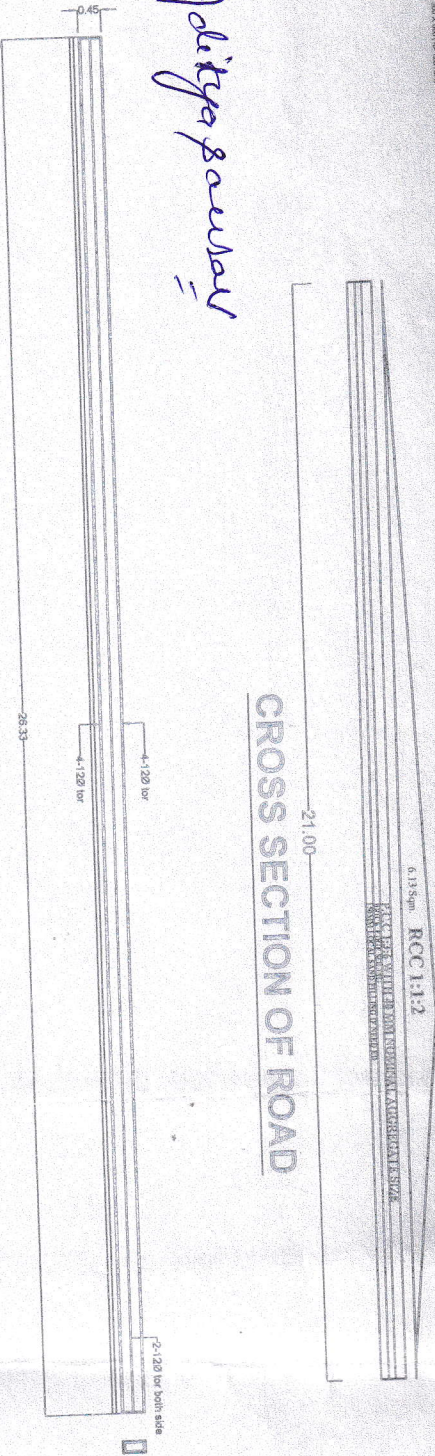

Aditya Kumar

CIVIL CONSTRUCTION WORK FOR THE CONSTRUCTION
OF ROAD FROM MAIN GATE TO INDUSTRIAL DRAIN AT
HAJIPUR DAIRY PLANT, HAJIPUR.

DEV-CHANDRA CREATIVE ASSOCIATES
ARCHITECTS & ENGINEERS CONSULTANT

