

VAISHAL PATLIPUTRA DUGDH UTPADAK SAHKARI SANGH LTD

PATNA DAIRY PROJECT

Feeder Balancing Dairy Complex, Phulwarisharif, Patna – 801505

Phone – 0612-2252553, 2252542, 2251622, Fax-2250325

Email :- vpmunin@gmail.com

PDP: PUR: 976

Dated: 22.05.2019

SHORT TENDER NOTICE

Sealed Tender is invited from experienced party for **civil work for Whole Day Booth Cattle Feed sale at CFP, Jagdeo path, Patna**. The details scope of work is attached herewith as per Annexure –I
Interested parties may submit their quotation latest by 15.06.2019 by 5.00 pm in sealed envelope addressed to Managing Director, VPDUSS Ltd., Patna superscribing on the top of the envelope Tiles **“ Whole Day Booth Cattle Feed sale, at CFP, Jagdeo path, Patna”**.

Incharge(MM)

Enclosure: As above

Note: 1) The rate should be all inclusive FOR FBD
2) All the legal document i.e. Photo, ID Proof
Service Tax papers, etc (Xerox is to be enclosed)

CC: Notrice Board, FBD, CFF, HCC
Patnadairy.org

**Civil Construction work Whole day Booth for Cattle Feed
Sale, at CFP, Jagdeo Path, Patna**

Sn	Description of work	Unit	Qty
1.	Dismantling work	M ³	6.625
2.	Earth Cutting	M ³	1.45
3.	Local Sand Filling	M ³	62.72
4.	Flat Brick Soling	M ²	46.60
5.	(a) RCC (1:1.5)	M ³	7.04
	(b) RCC (1:1.5)	M ³	3.98
6.	Reinforcement - 06mm	kg	116.10
	08mm	kg	163.37
	10mm	kg	168.81
	12mm	kg	181.86
7.	Brick work	M ³	23.67
8.	Plaster 15 mm (1:6)	M ²	217.80
9.	Plaster & Punning	M ²	35.2
10.	(a) Tiles work Floor	M ²	12.88
	(b) Tiles work Wall	M ²	18.96
11.	False Ceiling	M ²	14.5
12.	Rolling Shutter	M ²	2.99
13.	Window	M ²	1.62
14.	Aluminium work	M ²	3.60
15.	Truss & Purling	Kg	291.30
16.	Shuttering	M ²	52.68



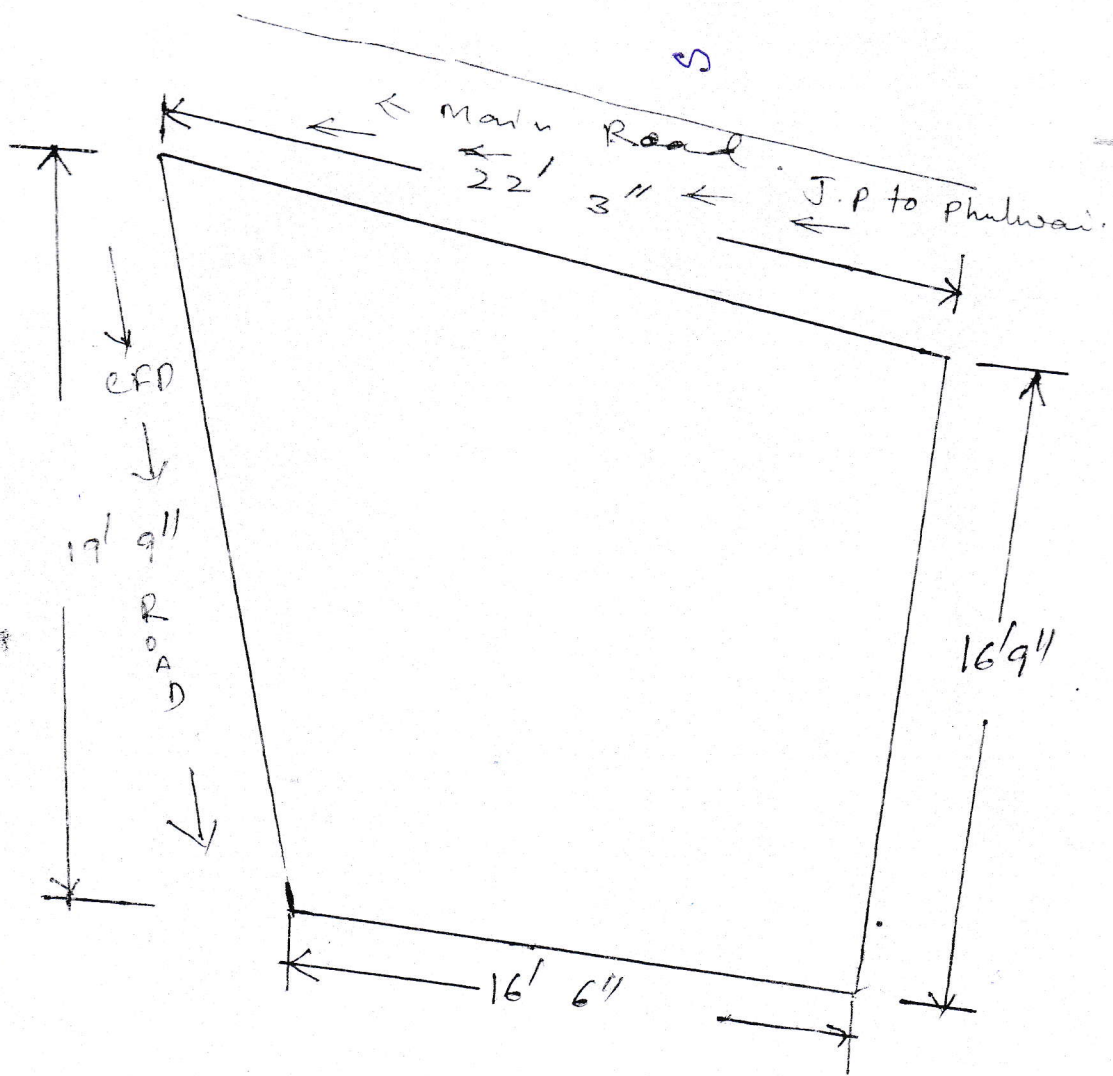

LAND PIECE of CFF FOR
MILK BOOTH AREA

DA.