

VAISHAL PATLIPUTRA DUGDH UTPADAK SAHKARI SANGH LTD

PATNA DAIRY PROJECT

Feeder Balancing Dairy Complex, Phulwarisharif, Patna – 801505

Phone – 0612-2252553, 2252542, 2251622, Fax-2250325

Email :- vpmu.pur@gmail.com

PDP: PUR:

4033

Dated: 20.10.2022

TENDER NOTICE

Sealed Tender is invited from experienced party for **Civil work for making area around two soft water silos smooth at Hajipur Dairy, Hajipur.** The details scope of work as per BOQ with diagrams attached herewith.

Interested parties may submit their quotation latest by 05.11.2022 by 5.00 pm in sealed envelope addressed to Managing Director, VPDUSS Ltd., Patna super scribing on the top of the envelope Tiles "**Civil work for making area around two soft water silos smooth at Hajipur Dairy, Hajipur.**"

Bidder must be registered for civil work in Bihar Govt or COMFED, Patna.



Manager (MM)\

Enclosure: As above

Note: 1) The rate should be all inclusive FOR FBD
2) All the legal document i.e. Photo, ID Proof
Service Tax papers, etc (Xerox is to be enclosed)

CC: Notrice Board, FBD, CFF, HCC
Patnadairy.org

Bill of quantities(BOQ)

WORK:- CIVIL WORK FOR MAKING AREA AROUND TWO SOFTWATER SILOS SMOOTH

S.No.	SOR 2022	NAME OF WORK	UNIT	QTY.	RATE	AMOUNT
1	p-101/2.29.1	Surface dressing of the ground including removing vegetation and inequalities not exceeding 15 cm deep and disposal of rubbish, lead upto 50 m and lift upto 1.5 m for all kind of soil	Sqm	400	13.55	5420.000
2	p-101/2.28	Supplying and filling in plinth with local sand and under floors including watering, ramming, consolidating and dressing complete	CUM	40	287.3	11492.000
3	P-192/11.72	providing designation 100A one brick FLAT soling joints filled with local sand including cost of watering, taxes, royalty all complete as per building specification and direction of E/I	SQM	400	283.3	113320.000
4	p-104/4.1.5	Providing and laying in position cement concrete of grade 1:3:6(1Coarse aggregate:3 coarse sand:6 Cement)	CUM	30	3434	103020.000
5	p-208/13.17.2	12 mm cement plaster 1:4(1 cement : 4 coarse sand) with floating coat of neat cement	SQM	400.000	192.2	76880.000
TOTAL ESTIMATED COST(A)=						310132.000
6	D/A	Carriage of materials				-
1	A	Carriage of Materials				
	a	Graded Stone aggregate 190 km.	Cum.	28.200	3599.90	101,517.18
	b	Coarse sand 31 km.	Cum.	20.263	776.22	15,728.70
	c	Bricks 8km	1000No.	12.912	1177.60	15,205.17
	d	Reinforcement (Steel)	Tonne	0.000	247.10	-
	e	Cement	Tonne	8.904	247.10	2,200.18
	f	Local Sand	Cum	40.000	274.46	10,978.40
2	B	Difference of Cost of Materials				-
	I	Bricks	1000No.	12.912	317.40	4,098.27
	II	Cement	Tonne	8.904	207.00	1,843.13
		Carriage charge(B)=			Rs.	151,571.03
		GRAND TOTAL(say)(A+B)=				461,703

In words: Rs Four Lakh Sixty One Thousand Seven Hundred Three Only

I AGREE & READY TO DO THIS WORK

		In Numeric	In words
1.0	ON THE GIVEN B.O.Q RATE		
2.0	ABOVE THE B.O.Q RATE(PRESENT)		
3.0	BELOW THE B.O.Q RATE(PRESENT)		

Signature of client

Signature of bidder

Roh
Signature of client
[Signature]
18/10/2022

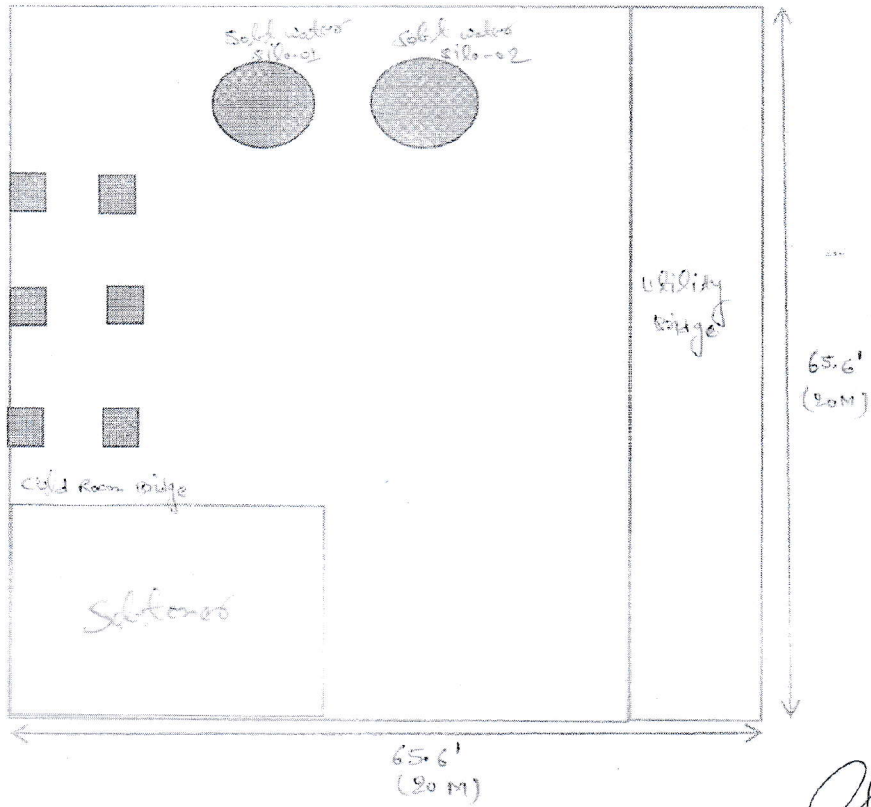

PROPOSED PLAN OF CONCRETING AREA AROUND SOFTWATER SILOS

Robit

32/08/2006

Jawar Singh
29/08/22